

Soils Map

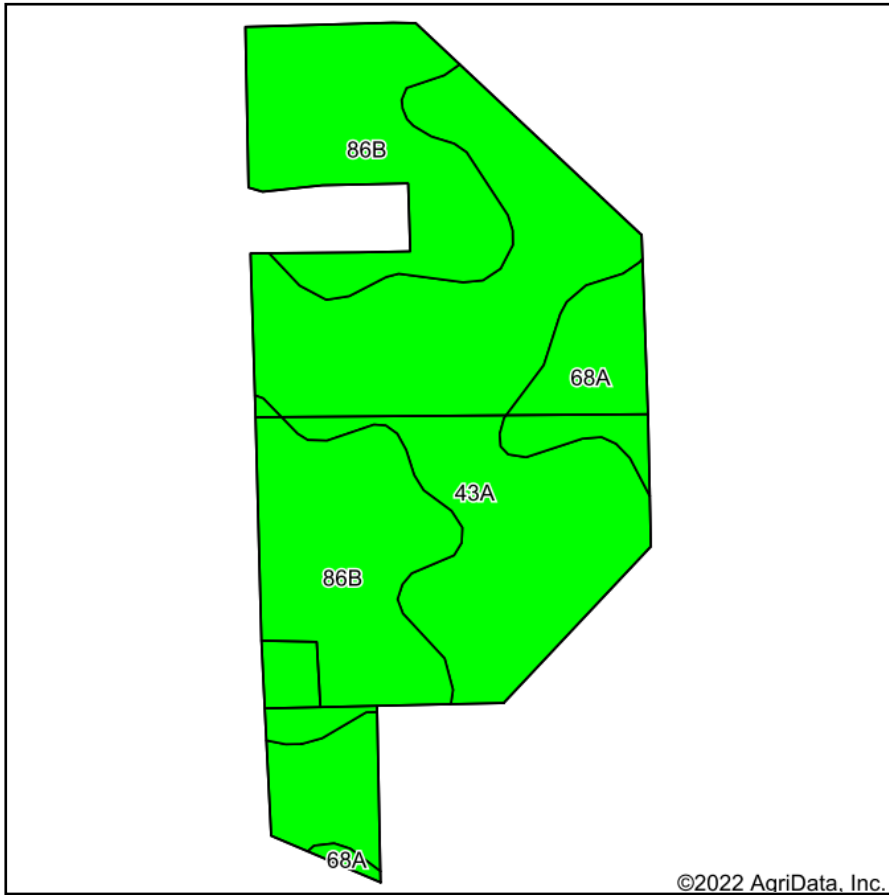

Soils data provided by USDA and NRCS.

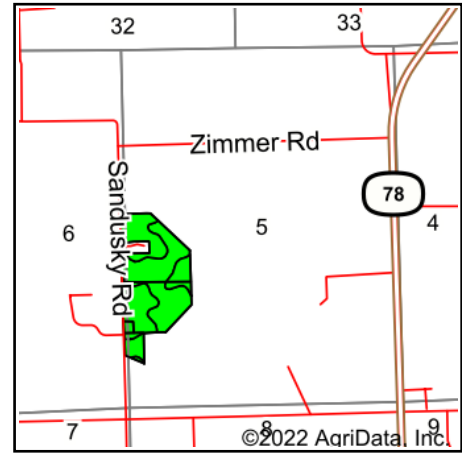

State: **Illinois**
 County: **Morgan**
 Location: **5-15N-10W**
 Township: **Jacksonville No. 22**
 Acres: **62.54**
 Date: **11/4/2022**

RAHE Appraisal & Auctioneer
 217-473-4095

Maps Provided By:



Area Symbol: IL137, Soil Area Version: 12							
Code	Soil Description	Acres	Percent of field	Il. State Productivity Index Legend	Corn Bu/A	Soybeans Bu/A	Crop productivity index for optimum management
43A	Ipava silt loam, 0 to 2 percent slopes	32.48	51.9%		191	62	142
**86B	Oscos silt loam, 2 to 5 percent slopes	24.82	39.7%		**189	**59	**140
68A	Sable silty clay loam, 0 to 2 percent slopes	5.24	8.4%		192	63	143
Weighted Average					190.3	60.9	141.3

Table: Optimum Crop Productivity Ratings for Illinois Soil by K.R. Olson and J.M. Lang, Office of Research, ACES, University of Illinois at Champaign-Urbana. Version: 1/2/2012 Amended Table S2 B811

Crop yields and productivity indices for optimum management (B811) are maintained at the following NRES web site: <http://soilproductivity.nres.illinois.edu/>

** Indexes adjusted for slope and erosion according to Bulletin 811 Table S3

Soils data provided by USDA and NRCS. Soils data provided by University of Illinois at Champaign-Urbana.